



Roland Mews, Stepney Green, London, E1

BUTLER & STAG



Situated moments from the tranquil and leafy Stepney Green, is this two bedroom mews house offering great light and space throughout.



- Two Double Bedrooms
- Secluded Private Close
- Conversion Property
- Unfurnished
- Mews House
- Private Patio
- Moments from Stepney Green Station
- Available Now!

Set within a secluded private close, Roland Mews is a charming location and this equally delightful mid-terrace house features a modern kitchen and a cosy reception room, ideal for relaxing or entertaining guests. With two double bedrooms and a contemporary bathroom on the first floor, there's plenty of space for a couple requiring a guest room/home office or for two discerning professional sharers.

Step outside to your very own small private patio area, where you can enjoy a morning coffee or unwind after a long day. The property, a former Scouts Hall sympathetically converted into a period-style house, exudes character and history while offering all of the modern conveniences you could desire.

Built in 2000, this 780+ Sq/Ft home offers a unique opportunity to live in a quiet pocket of East London that is simultaneously just moments from the action and Stepney Green underground station, providing quick and easy access across the capital.

Offered unfurnished and available now!

EPC Rating C
Council Tax Band D





Roland Mews

Approx. Gross Internal Area 73.4 sq. metres (789.8 sq. feet)

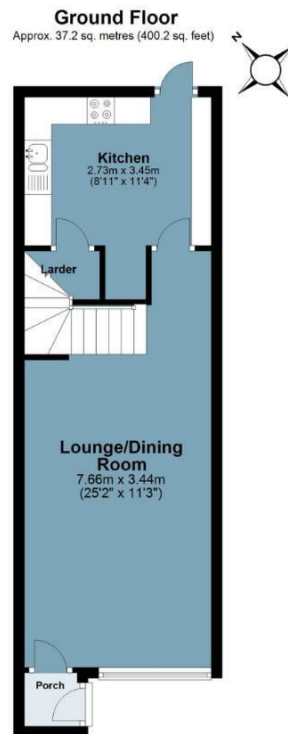

BUTLER & STAG

First Floor
Approx. 36.2 sq. metres (389.7 sq. feet)

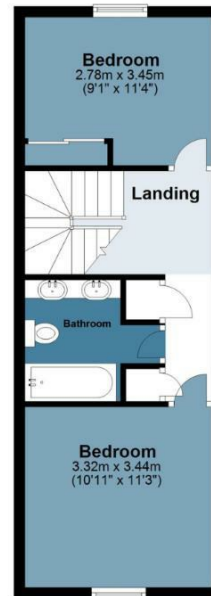

Measurements are approximate and for illustration purposes only. While we do not doubt the accuracy and completeness, we advise you conduct a careful independent assessment of the property to determine monetary value
© @modephotouk www.modephoto.co.uk

IMPORTANT NOTICE - These particulars have been prepared in good faith and they are not intended to constitute part of an offer or contract. We have not performed a structural survey on this property and the services, appliances and specific fittings have not been tested. All photographs, measurements, floor plans and distances referred to are given as a guide and should not be relied upon.

BUTLER & STAG

☎ 020 8102 1236

🏠 508 Roman Road, Bow, London, E3 5LU

✉ bow@butlerandstag.com

www.butlerandstag.uk